

# 58,534 SF

## Industrial Space For Lease



## Prologis Park Kent 8

6250 S. 196th Street  
Kent, WA 98032  
USA

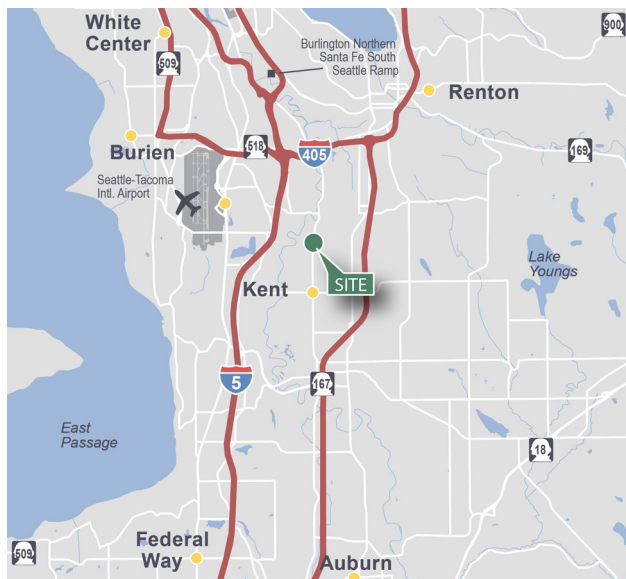

### LOCATION

- Great access to I-5 and Highway 167
- North Kent Valley

### FACILITY

- Total building size: 75,591 SF
- Total available: 58,534 SF
- Total office space: 2,883 SF on first floor  
2,626 SF on mezzanine
- 22' - 24' clear height
- 21 dock-high doors, 18 with EOD & 2 with pit levelers
- 1 grade-level door
- Comcast fiber in building

### ADVANTAGES AND AMENITIES

- End cap space
- Corporate image
- Visibility onto S. 196th Street

# 58,534 SF

## Industrial Space For Lease

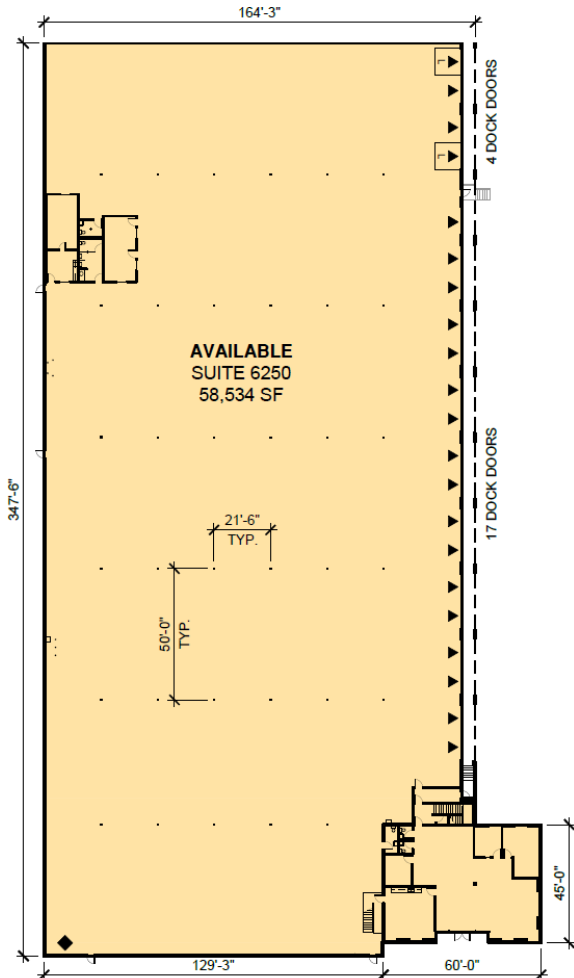

**FLOOR & MEZZANINE PLANS**  
NOT TO SCALE

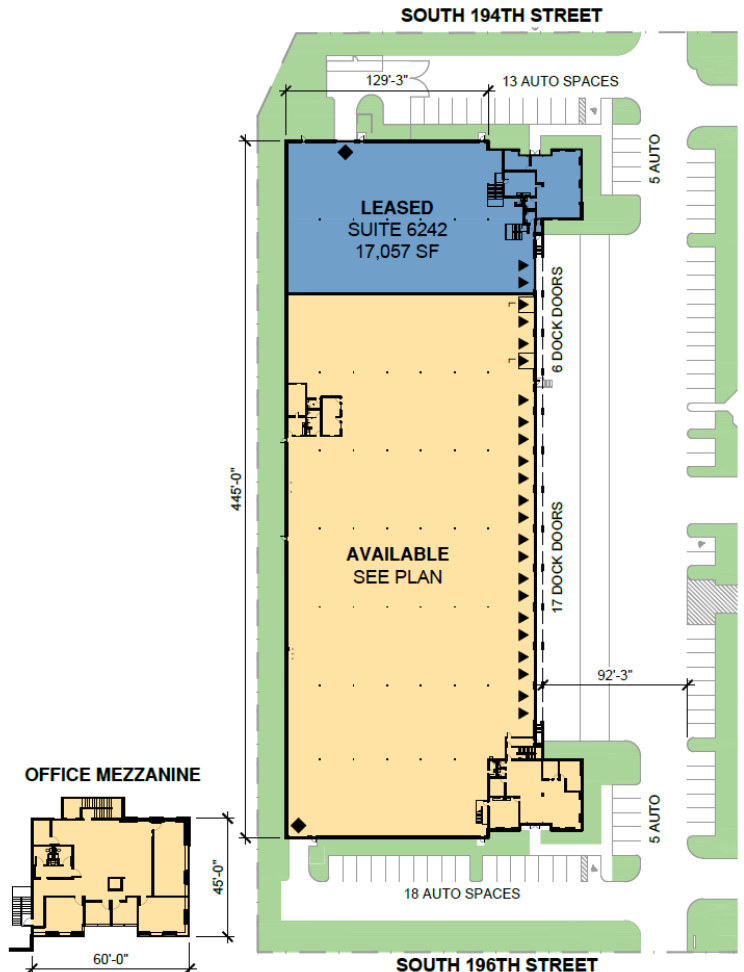

**SITE PLAN**  
NOT TO SCALE



Jones Lang LaSalle Brokerage, Inc.

**JLL**  
Les Boudwin, SIOR  
les.boudwin@am.jll.com  
ph +1 425 974 4023  
cell +1 206 679 6393  
225 108th Avenue NE  
Suite 550  
Bellevue, WA 98004 USA

**JLL**  
Scott Carter  
scott.carter@am.jll.com  
ph +1 425 974 4004  
cell +1 425 761 5880  
225 108th Avenue NE  
Suite 550  
Bellevue, WA 98004 USA

**JLL**  
David Cahill  
david.cahill@am.jll.com  
ph +1 425 974 4002  
cell +1 206 930 5599  
225 108th Avenue NE  
Suite 550  
Bellevue, WA 98004 USA

**Prologis**  
Mark Roddy  
mroddy@prologis.com  
ph +1 206 414 7617  
cell +1 253 514 0299  
12720 Gateway Drive  
Suite 110  
Tukwila, WA 98168 USA