

# 60,417 SF

Industrial Space For Lease



## Prologis Hanover Park



5800 Turnberry Drive  
Hanover Park, IL 60133 USA

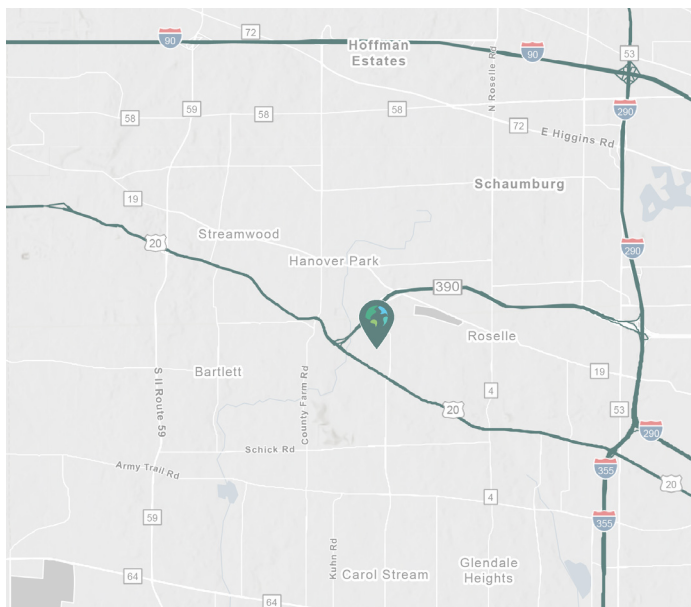

### LOCATION

- Located in the prestigious Turnberry Lakes Business Center
- Easy access to Elgin-O'Hare Expressway (I-390)
- Close proximity to I-290 and I-355

### FACILITY

- 244,888 sf building
- 60,417 sf available
- 3,915 sf office
- 7 exterior docks
- 1 drive-in door
- 58 parking spaces
- 28' clearance
- ESFR sprinkler system

### ADVANTAGES AND AMENITIES

- Large truck court
- Low DuPage County taxes
- Institutionally owned and managed

Prologis Essentials: your single-source service for efficient move-in and operations at [prologisessentials.com](https://www.prologisessentials.com)

# 60,417 SF

Industrial Space For Lease



## Prologis Hanover Park

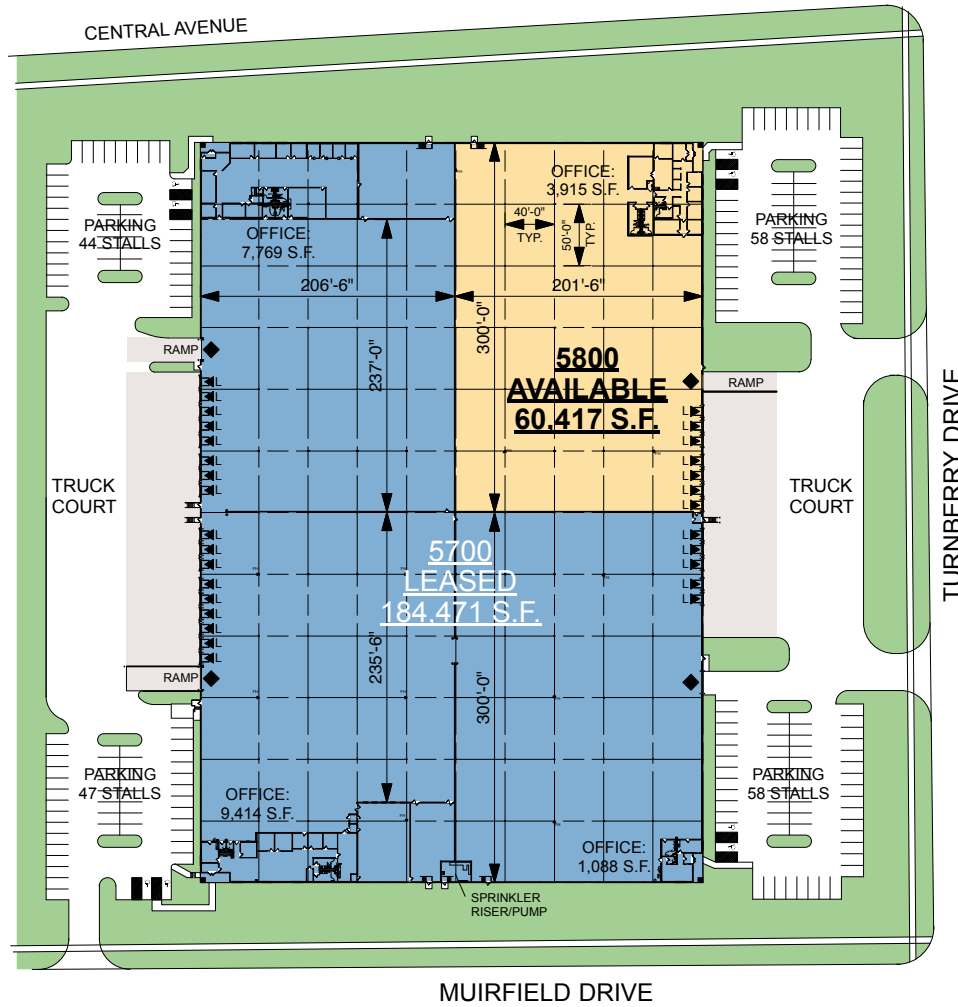

**Lee & Associates**  
Kenneth Franzese, SIOR  
kfranzese@lee-associates.com  
ph +1 773 355 3005  
cell +1 847 456 4213  
9450 W. Bryn Mawr Ave.  
Suite 550  
Rosemont, IL 60018 USA

**Lee & Associates**  
John Cassidy, SIOR  
jcassidy@lee-associates.com  
ph +1 773 355 3006  
cell +1 312 371 0098  
9450 W. Bryn Mawr Ave.  
Suite 550  
Rosemont, IL 60018 USA

**Prologis**  
Matthew Mannina  
mmannina@prologis.com  
ph +1 847 292 3939  
cell +1 847 791 3827  
6250 N. River Rd.  
Suite 1100  
Rosemont, IL 60018 USA

**Prologis**  
Maggie Tullier  
mtullier@prologis.com  
ph +1 847 292 3943  
cell +1 847 420 4145  
6250 N. River Rd.  
Suite 1100  
Rosemont, IL 60018 USA

Prologis Essentials: your single-source service for efficient move-in and operations at [prologisessentials.com](http://prologisessentials.com)

No warranty or representation, expressed or implied, is made as to the accuracy of the information contained herein, and same is submitted subject to error and omissions.