

8,480 SF

Industrial Space For Lease



Prologis Southfield



5651 Old Dixie Highway, Suite 102
Forest Park, GA 30297 USA

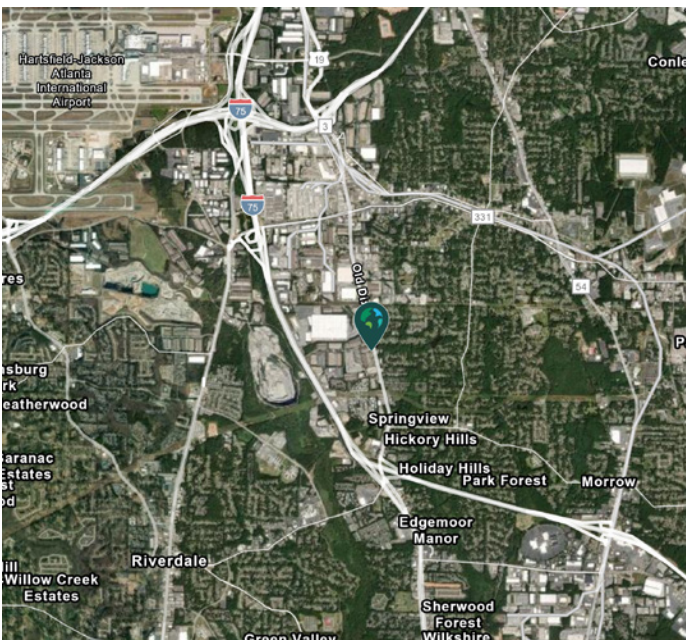

LOCATION

- Key Distances:
 - I-75: 0.8 miles
 - I-285: 2.6 miles
 - Hartsfield-Jackson Atlanta International Airport: 4.9 miles
 - I-85: 8 miles
- Tax Incentives: Clayton County is a designated Tier 1 county, \$3,500 per qualified job tax credit for up to 5 years

FACILITY

- 34,288 SF building
- 8,480 SF available
 - 3,138 SF office
- Three (3) dock doors; one (1) pit leveler
- One (1) drive-in door
- Sixteen (16) auto parking spaces
- 18' clear height
- 120' building depth
- 35' bay width
- Power: 120/240V, 200A

ADVANTAGES AND AMENITIES

- Prologis Clear Lease® – Know your lease expenses and capital costs with greater certainty before you sign

Your single-source service for efficient move-in and operations: [prologisessentials.com](https://www.prologis.com)



Scan the QR code for more info!

8,480 SF

Industrial Space For Lease



Prologis Southfield

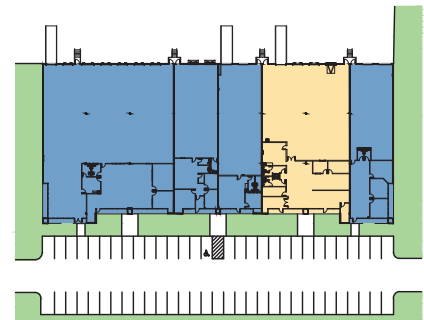
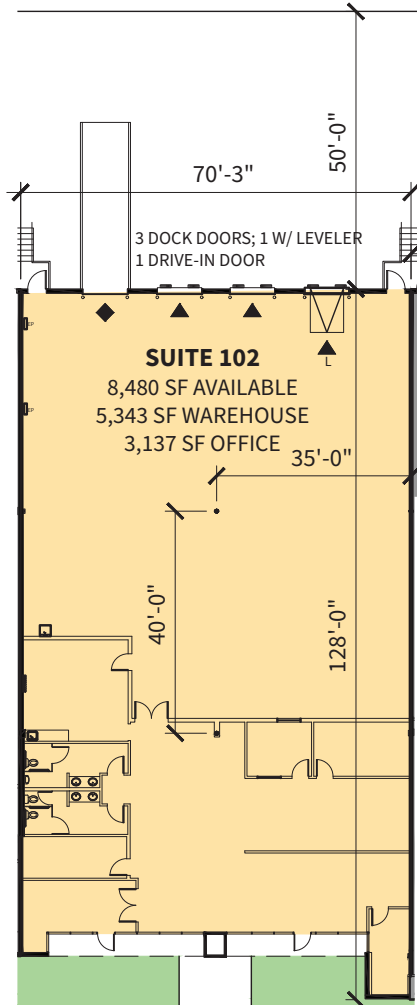

KEY PLAN

LEGEND:

- ▲ DOCK DOOR
- ▲
└ DOCK DOOR W/LEVELER
- ◆ DRIVE-IN DOOR
- ▲
G ON-GRADE DOOR
- ▨ EDGE OF DOCK LEVELER
- ▽ PIT LEVELER
- LAND
- LEASED AREA
- VACANT AREA



Seefried Industrial
Joseph Kriss

josephk@seefriedproperties.com
ph +1 404 233 0204
cell +1 678 362 4641
3333 Riverwood Parkway SE
Suite 200
Atlanta, GA 30339 USA

Seefried Industrial
Tripp Ausband

tausband@seefriedproperties.com
ph +1 404 233 0204
cell +1 770 825 3391
3333 Riverwood Parkway SE
Suite 200
Atlanta, GA 30339 USA

Prologis
Sarah Stafford

sstafford@prologis.com
ph +1 404 760 7214
cell +1 404 561 8378
3350 Peachtree Road
Suite 850
Atlanta, Georgia 30326 USA