

# 1,575 SF

Industrial Space For Lease



## Prologis Park Trans-Pacific 11



4706B 20th Street East  
Fife, WA 98424 USA



### LOCATION

- Located less than half a mile away from Interstate 5
- Three miles to the Port of Tacoma
- Retail frontage location

### FACILITY

- ±1,575 SF office
- Available now

### ADVANTAGES AND AMENITIES

- LED lighting upgrade
- No City of Fife B&O Taxes
- Low operating expenses
- Move-in ready

**Prologis Essentials: your single-source service for efficient move-in and operations at [prologisessentials.com](http://prologisessentials.com)**

[www.prologis.com](http://www.prologis.com)

# 1,575 SF

Industrial Space For Lease



## Prologis Park Trans-Pacific 11

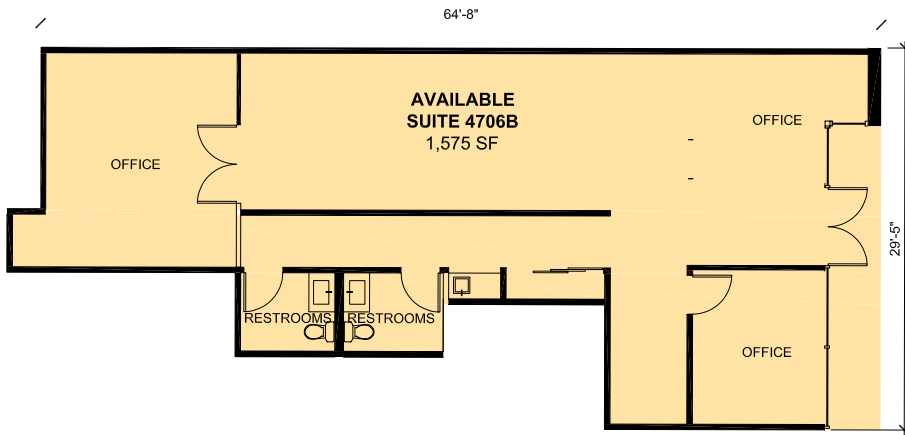
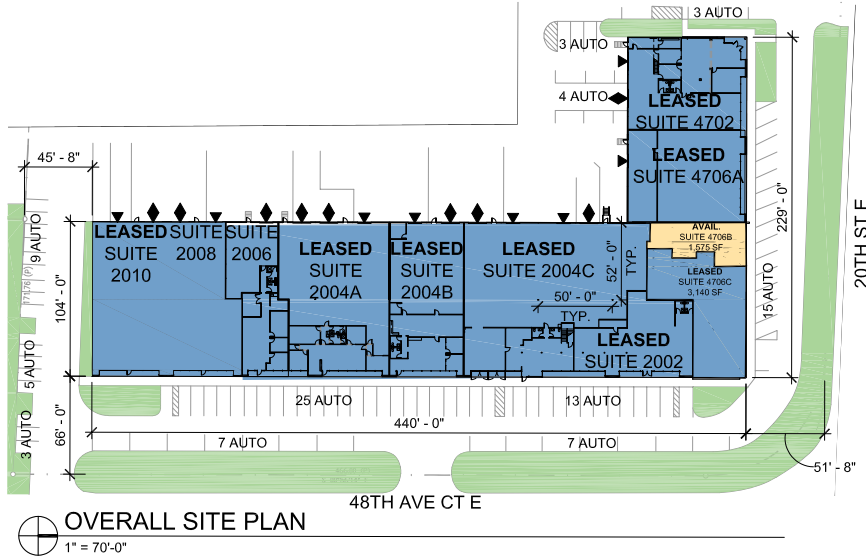

### CBRE, Inc.

Monte Decker, CCIM  
monte.decker@cbre.com  
ph +1 253 596 0041  
1201 Pacific Avenue  
Suite 1502  
Tacoma, WA 98402 USA

### Prologis

Mark Roddy  
mroddy@prologis.com  
ph +1 206 414 7617  
12720 Gateway Drive  
Suite 110  
Tukwila, WA 98168 USA

© 2023 CBRE, Inc. All rights reserved. This information has been obtained from sources believed reliable but has not been verified for accuracy or completeness. You should conduct a careful, independent investigation of the property and verify all information. Any reliance on this information is solely at your own risk. SD 6.7.23

**Prologis Essentials: your single-source service for efficient move-in and operations at [prologisessentials.com](https://www.prologisessentials.com)**

No warranty or representation, expressed or implied, is made as to the accuracy of the information contained herein, and same is submitted subject to error and omissions.