

# 4,177 SF

Industrial Space For Lease



## Prologis Park Trans-Pacific 9



3202 20th Street East  
Fife, WA 98424 USA



### LOCATION

- Immediate access to Interstate 5
- Three miles to the Port of Tacoma main gate
- No City of Fife B&O taxes

### FACILITY

- Shell: 4,177 SF
- Office: 2,398 SF
- Drive-in door: 1
- Dock-high door: 1
- Available January 1, 2024

### ADVANTAGES AND AMENITIES

- Use Prologis Essentials to help with pricing on forklifts and racking for your move-in

**Prologis Essentials: your single-source service for efficient move-in and operations at [prologisessentials.com](https://www.prologisessentials.com)**

# 4,177 SF

Industrial Space For Lease



## Prologis Park Trans-Pacific 9



- LEGEND:
- ▲ DOCK POSITION
  - ▲ OVERSIZED DOCK POSITION
  - ▲ DOCK POSITION W/ LEVELER
  - ◆ DRIVE-IN DOOR
  - RAIL DOOR
  - LAND
  - LEASED AREA
  - AVAILABLE AREA

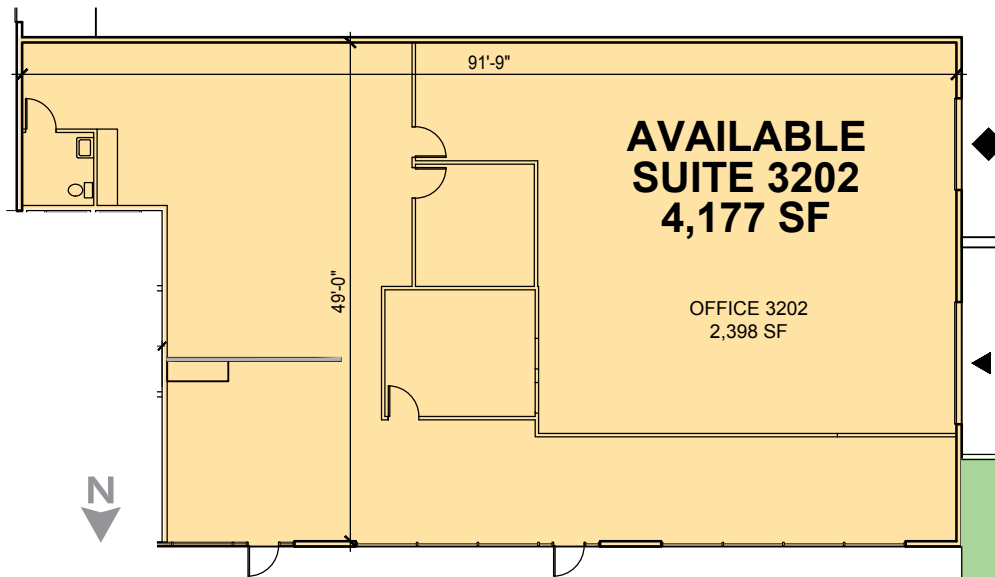

**CBRE, Inc.**  
Monte Decker, CCIM  
monte.decker@cbre.com  
ph +1 253 596 0041  
1201 Pacific Avenue  
Suite 1502  
Tacoma, WA 98402 USA

**Prologis**  
Mark Roddy  
mroddy@prologis.com  
ph +1 206 414 7617  
12720 Gateway Drive  
Suite 110  
Tukwila, WA 98168 USA

© 2023 CBRE, Inc. All rights reserved. This information has been obtained from sources believed reliable but has not been verified for accuracy or completeness. You should conduct a careful, independent investigation of the property and verify all information. Any reliance on this information is solely at your own risk. CBRE and the CBRE logo are service marks of CBRE, Inc. All other marks displayed on this document are the property of their respective owners, and the use of such marks does not imply any affiliation with or endorsement of CBRE SD 8.23.23

**Prologis Essentials: your single-source service for efficient move-in and operations at [prologisessentials.com](https://www.prologisessentials.com)**

No warranty or representation, expressed or implied, is made as to the accuracy of the information contained herein, and same is submitted subject to error and omissions.