

# 108,162 SF

## Industrial Space For Lease



### Prologis Van Nuys Distribution Center

7850 Ruffner Ave,  
Van Nuys, CA 91406

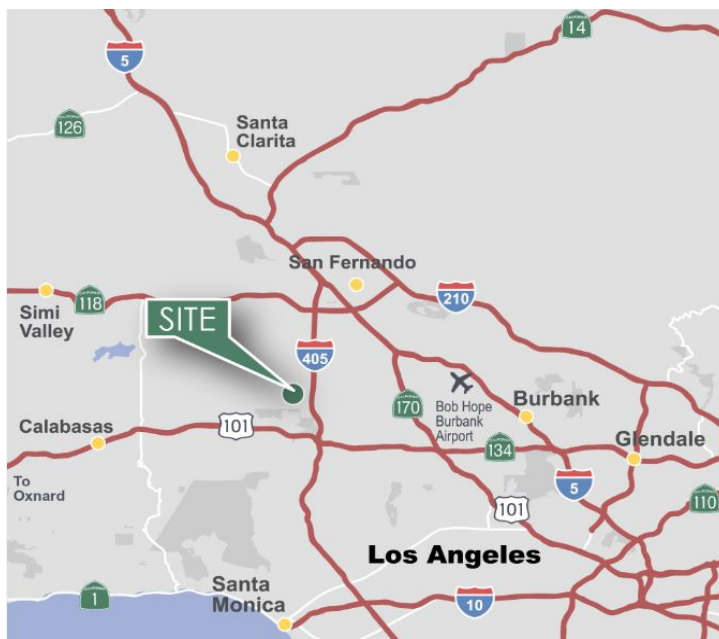

#### LOCATION

- Van Nuys Airport Business Park
- Strategic Central San Fernando Valley

#### FACILITY

- 108,162 SF
- ± 26,817 Total Office
- Elevator Served
- 21'5" Clear height
- 4,000 Amps, 277/480 Volts – (2) 2,000 Amp Panels
- Sprinkler Calculation: .50 GPM/2,000 SF
- Land: 199,320 SF
- Eight (8) Dock Load Levelers
- Exterior platform can accommodate over ten (10) dock high positions via seven (7) doors
- Approximately 167 parking spaces (parking needs to be verified since not all parking area is currently striped).

#### ADVANTAGES AND AMENITIES

- Part of a Business Park Environment
- Prologis Ownership
- 26 Minutes From Burbank Airport



# 108,162 SF

## Industrial Space For Lease

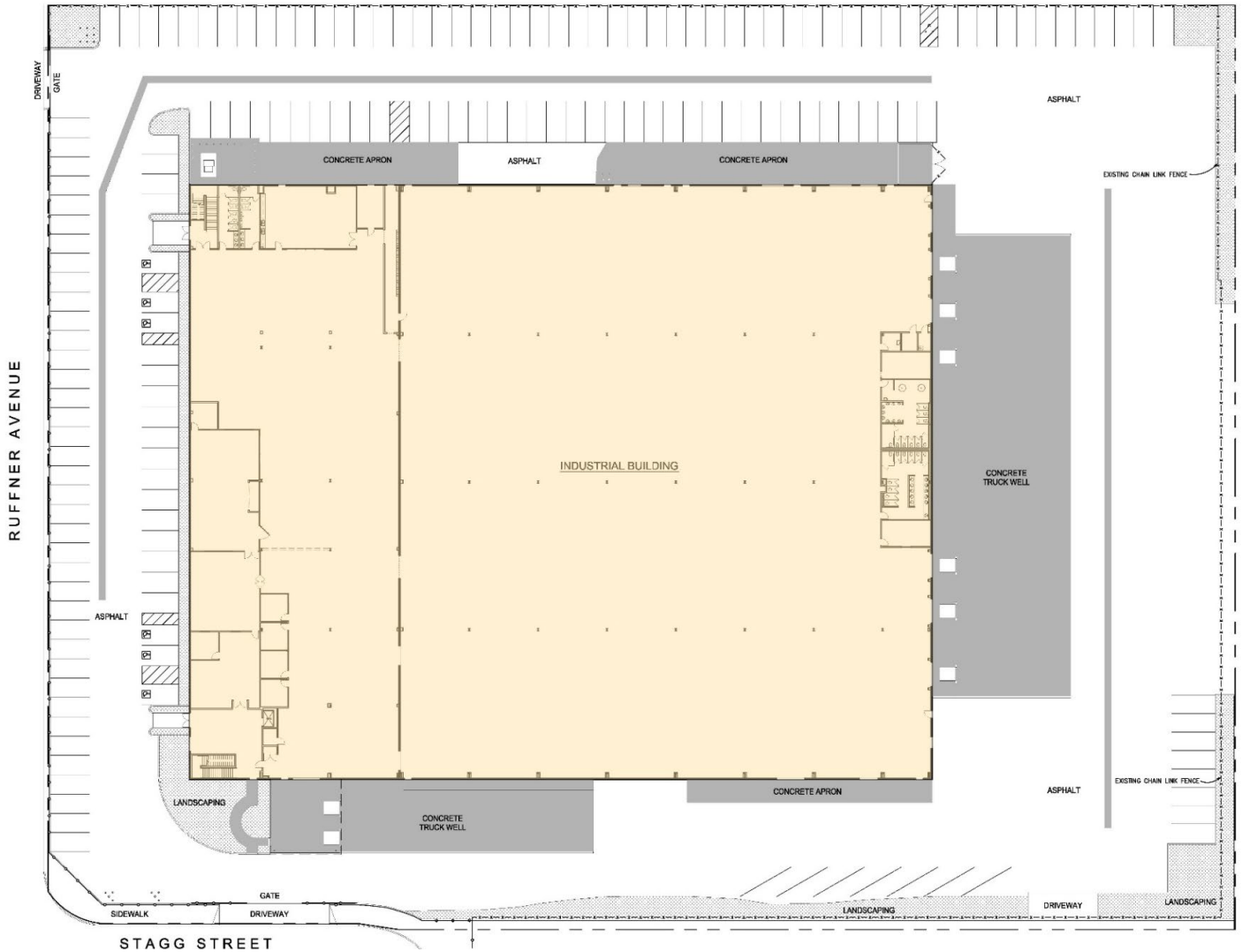

## CBRE

CBRE, Inc.

Bennett Robinson

Lic. 00984312

[bennett.robinson@cbre.com](mailto:bennett.robinson@cbre.com)

ph +1 818 907 4608

cell +1 818 458 7853

5921 Owensmouth Avenue  
Woodland Hills, CA 91367 USA

234 S Brand Blvd, Suite 800  
Glendale, CA 91204 USA

Prologis

Lisa Reddy

Lic. 01327922

[reddy@prologis.com](mailto:reddy@prologis.com)

ph +1 562 345 9200

17777 Center Court Drive N.

Suite 100

Cerritos, CA 90703 USA