

16,693 SF

Industrial Space For Lease



Prologis Kennesaw



1150 Cobb International Place NW, Suite E
Kennesaw, GA 30152 USA

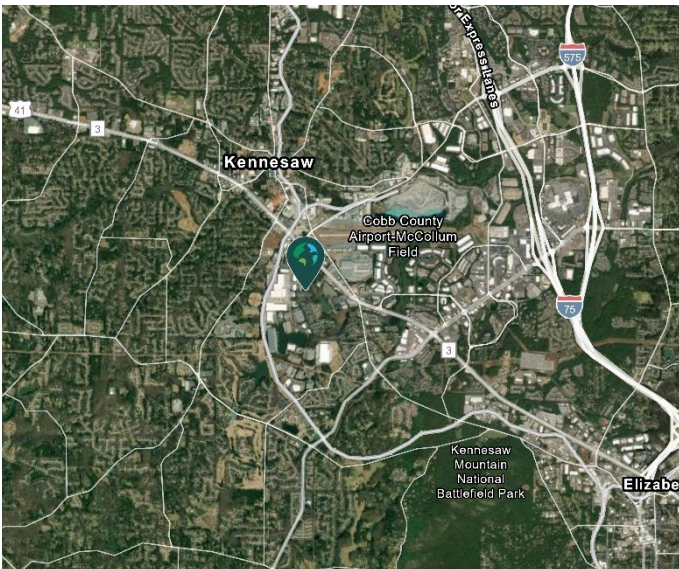

LOCATION

- City of Kennesaw – Heavy Industrial Zoning
- Exceptional amenities nearby (restaurants, shopping, etc.)
- Key distances: I-75 (3.1 mi.), I-575 (4.1 mi.), I-285 (13.2 mi.), Hartsfield-Jackson International Airport (36 mi.)

FACILITY

- 68,093 SF building
- 16,693 SF available
 - 2,861 SF office
- 24' minimum clear height
- Three (3) dock-high doors
- One (1) drive-in door
- 40' x 39'-9" column spacing
- Eighteen (18) auto parking spaces
- LED office and warehouse lighting
- Rear-load configuration
- Power: 277/480v, 200 amps

ADVANTAGES AND AMENITIES

- Prologis Clear Lease® – Know your lease expenses and capital costs with greater certainty before you sign



Scan the QR code for more info!

Your single-source service for efficient move-in and operations: [prologisessentials.com](https://www.prologisessentials.com)

16,693 SF

Industrial Space For Lease



Prologis Kennesaw



LEGEND:

- ▲ DOCK DOOR
- ▲ DOCK DOOR W/LEVELER
- ◆ DRIVE-IN DOOR
- ▲ ON-GRADE DOOR
- G EDGE OF DOCK LEVELER
- ▭ PIT LEVELER
- LAND
- LEASED AREA
- VACANT AREA

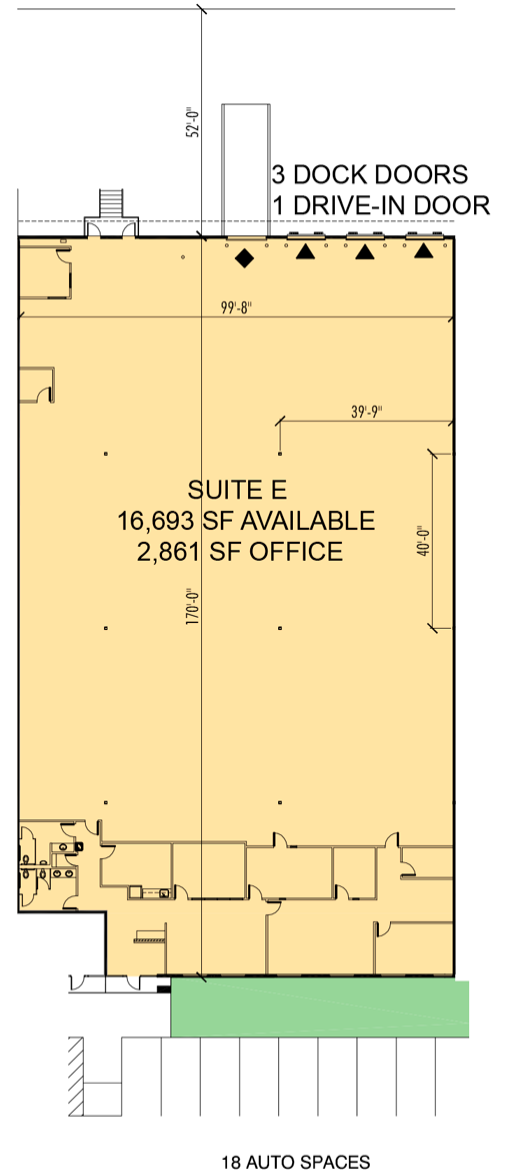

Reliant

Drew Venable

dvenable@reliant-re.com
 ph +1 404 760 7186
 cell +1 229 392 8745
 3490 Piedmont Road NE
 Suite 1025
 Atlanta, GA 30305 USA

Reliant

Mike Weinberger

mweinberger@reliant-re.com
 ph +1 404 760 7183
 cell +1 770 891 7235
 3490 Piedmont Road NE
 Suite 1025
 Atlanta, GA 30305 USA

Prologis

DeVonne Boler

dboler@prologis.com
 ph +1 404 760 7261
 cell +1 267 252 2143
 3475 Piedmont Road NE
 Suite 650
 Atlanta, GA 30305 USA