

PROLOGIS MELROSE PARK 5

726 MELROSE AVE.
NASHVILLE, TN 37211

TOTAL FOOTPRINT 137,479 SF

OFFICE: 99,620 SF
WAREHOUSE: 37,859 SF

SUITE 684	SUITE 688
OFFICE: 4,732 SF	OFFICE: 1,905 SF
WAREHOUSE: 5,168 SF	WAREHOUSE: 8,814 SF

SUITE 696	SUITE 702
OFFICE: 5,134 SF	OFFICE: 9,173 SF
WAREHOUSE: 13,487 SF	WAREHOUSE: 0 SF

SUITE 708	SUITE 712
OFFICE: 11,044 SF	OFFICE: 6,390 SF
WAREHOUSE: 390 SF	WAREHOUSE: 0 SF

SUITE 718/726/732
OFFICE: 61,242 SF
WAREHOUSE: 10,000 SF

Dock Doors:	2
Drive-In:	7
Levelers:	3
Edge of Dock Levelers:	1
Car Parking:	349
EV Parking:	0
Trailer Parking:	0
Column Spacing:	32'-0" X 56'-0"
Speed Bay Depth:	VARIES
Truck Court Depth:	108'-0" 85'-4" 158'-4"

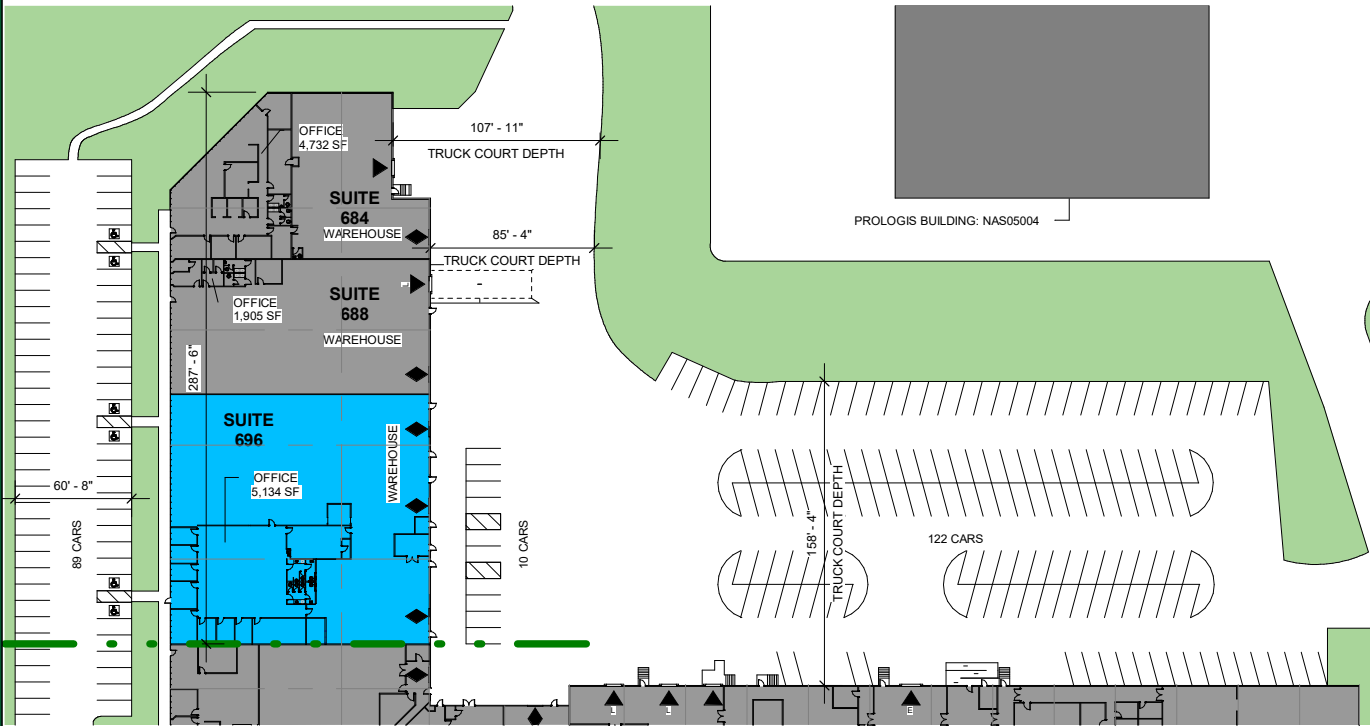

LEGEND

- | | | |
|----------------------|----------------------|-------------------------------|
| ■ UNDER CONSTRUCTION | ▲ DOCK DOOR | ▲ DOCK DOOR WITH LEVELER |
| ■ PLANNED | ◆ DRIVE-IN DOCK DOOR | ▲ DOCK DOOR WITH EDGE LEVELER |
| ■ AVAILABLE | | |
| ■ LEASED | | |
| ■ LAND | | |
| ■ WATER | | |
| ■ EV PARKING | | |
| ■ CONCRETE APRON | | |



RELEASE
WAIVER

The enclosed information/drawings are provided for general reference only, and it is your responsibility to verify the accuracy thereof, including, but not limited to, undertaking a field verification of critical dimensions, and any other necessary information, for confirmation of existing site conditions and/or potential discrepancies. They are not as-built documents, nor are they being supplied to aid in the preparation of future design or construction documents, but only as a general depiction of site orientation. By accepting and/or utilizing any information/drawings or other data set forth herein, you covenant and agree, to the fullest extent permitted by law, to indemnify and hold Prologis, L.P., and its affiliates, harmless from any damage, liability, claim, or cost, including reasonable attorney's fees and costs of defense, arising from your reliance on any inaccuracy or omission in the information/drawings.



MARKETING PLAN