

# 122,850 SF

**620 Westport Parkway  
Grapevine, TX 76051**

Prologis DFW 9



- Immediate proximity to DFW International Airport
- Easy access to major thoroughfares including SH 360, SH 121, and SH 114
- Secured truck court

## Property Features

Available Space	122,850 SF
Office SF	13,173 SF
Mezzanine Office SF	7,983 SF
Clear Height	24'
Column Spacing	45' x 45'
Dock Doors	31 (10' x 10')
Drive-in Doors	6 (12' x 16')
Dock Levelers	3 pit levelers, 28 edge of dock
Trailer Parking Spaces	53
Car Parking Spaces	182
Sprinklered	Yes



Unlock the full potential of your warehouse with one strategic, single-source partner.

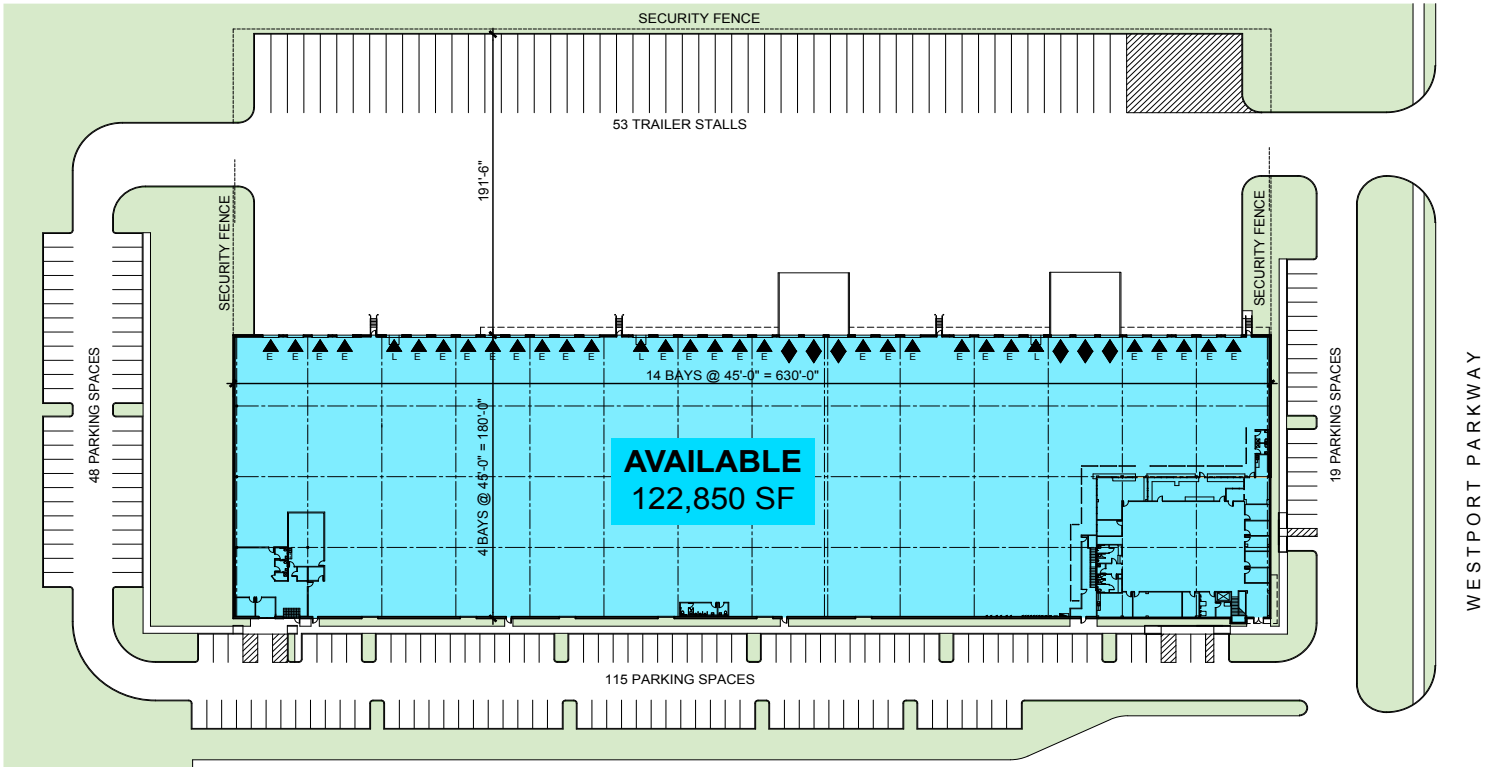

**Holt Lunsford Commercial**  
**Keaton Brice**  
 kbrice@holtlunsford.com  
 ph +1 972 421 1956  
 cell +1 972 983 7099

**Holt Lunsford Commercial**  
**Andrew Gilbert**  
 agilbert@holtlunsford.com  
 ph +1 972 280 8312  
 cell +1 817 988 5262

**Prologis**  
**Keesha Partida**  
 kpartida@prologis.com  
 ph +1 972 884 9224  
 cell +1 214 533 1161  
 prologis.com



Unlock the full potential of your warehouse with one strategic, single-source partner.



North Office | 2,796 SF

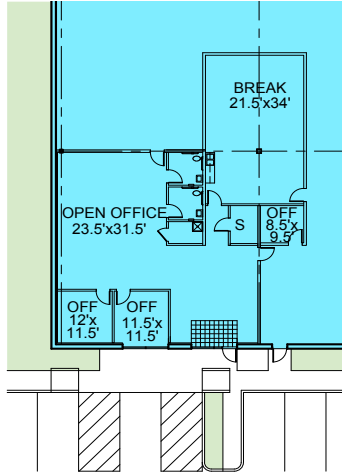

South Office | 10,377 SF

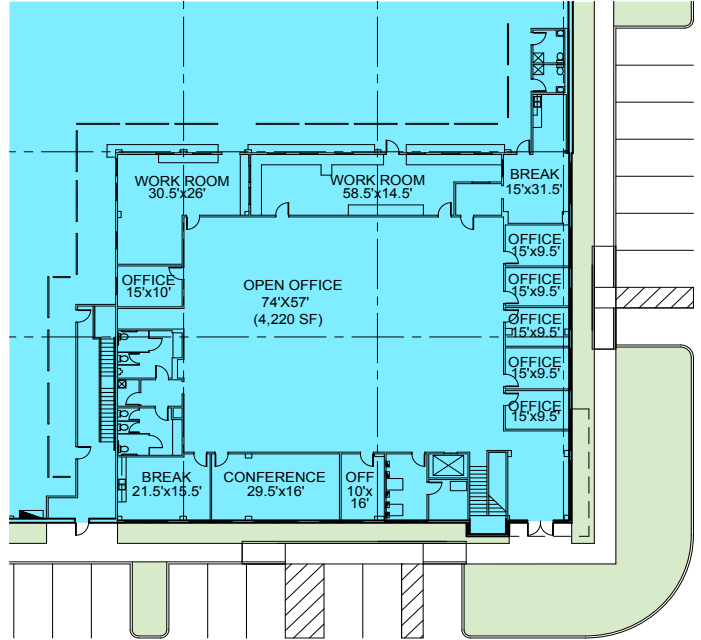

Mezzanine Office | 7,983 SF

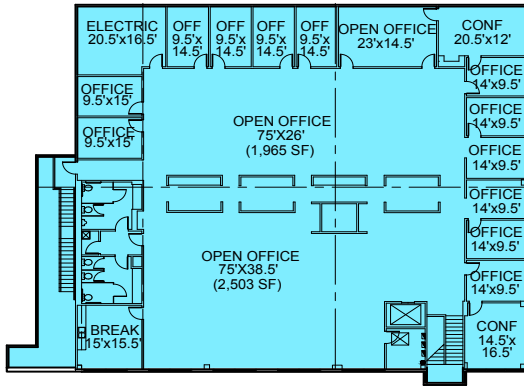

**Holt Lunsford Commercial**  
**Keaton Brice**  
 kbrice@holtlunsford.com  
 ph +1 972 421 1956  
 cell +1 972 983 7099

**Holt Lunsford Commercial**  
**Andrew Gilbert**  
 agilbert@holtlunsford.com  
 ph +1 972 280 8312  
 cell +1 817 988 5262

**Prologis**  
**Keesha Partida**  
 kpartida@prologis.com  
 ph +1 972 884 9224  
 cell +1 214 533 1161  
 prologis.com