

# 20,252 SF

**4101G Industry Drive E  
Fife, WA 98390**

Prologis Park Trans-Pacific 6

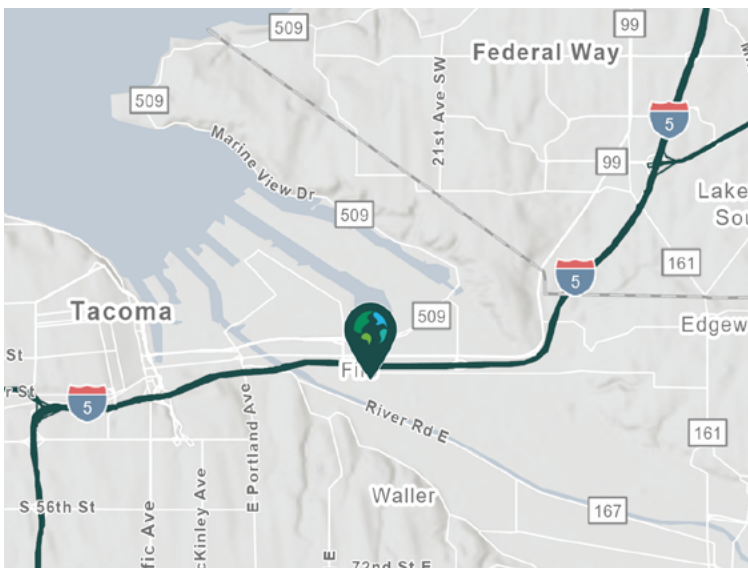

## Property Features

Available Space	20,252 SF
Warehouse SF	19,094 SF
Office SF	1,158 SF
Clear Height	24'
Column Spacing	50' x 50'
Dock Doors	13
Drive-in Doors	2
Available	June 1, 2026

- Located between exit 136 and exit 137 on Interstate 5.
- Three miles to the Port of Tacoma main gate.
- No City of Fife B&O taxes.



Unlock the full potential of your warehouse with one strategic, single-source partner.

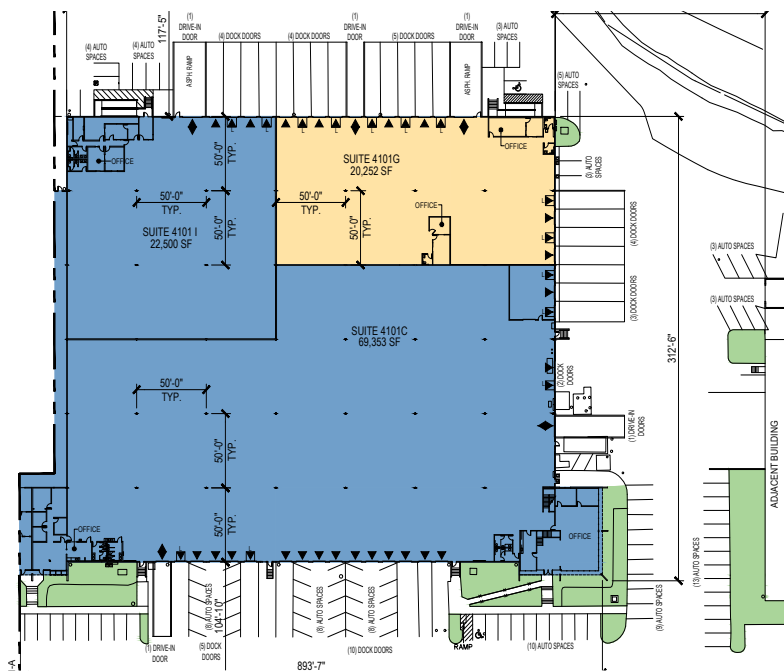
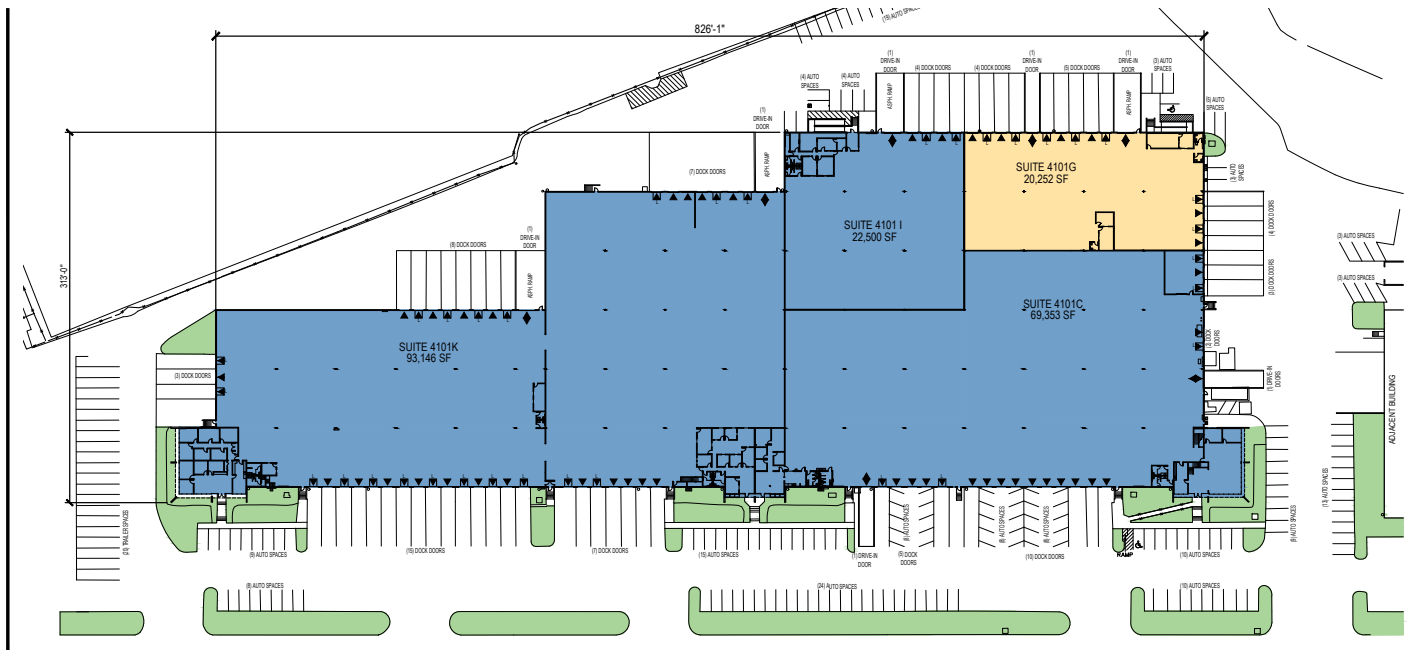

- LEGEND:**
- ▼ DOCK DOOR
  - L = PIT LEVELER
  - LE = EDGE OF DOCK LEVELER
  - DR = DOCK RESTRAINT
  - ◆ DRIVE-IN DOOR
  - RAIL DOOR
  - AVAILABLE AREA
  - LEASED AREA
  - LAND



CBRE, Inc.  
 Monte Decker  
 monte.decker@cbre.com  
 ph +1 253 596 0041

Prologis  
 Kimberley Nemethy  
 knemethy@prologis.com  
 ph +1 206 414 7616  
 prologis.com